

Drying cabinet for heavy duty overalls

FDC 6

FDC 6 especially developed for drying heavy duty overalls. Efficient and gentle drying procedure, the dryer has a capacity for 6 larger overalls. A large display shows with symbols and text. One system dries the overall from the outside. The other system dries the overalls from the inside. Three manual programmes and three automatic programmes, with the Humidity Tracking System (HTS). HTS is our new system that measures the level of humidity every second, to determine exactly when the textiles are dry. Programmes can also be set for other garments and station wear.



FEATURES

- Drying process from the outside and inside
- Adjustable programmes
- Drying capacity of 6 large overalls equal to 30 kg
- Drying procedure hardens the impregnation
- Gentle drying without friction
- Up to nine automatic programmes
- Indoor lighting
- Detachable hangers and racks for easier handling
- Programme ends with "cool down" to room temperature

OPTIONS

- Racks for gloves and boots in stainless steel
- Optional hangers to dry gloves and boots
- Optional hangers for other garments and station wear

MARKETS

Fire brigades, Airports, Oil platforms, Nuclear plants, Army, Rescue services

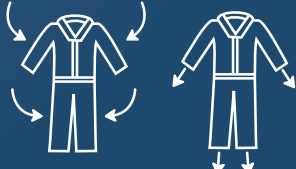



Two heating systems - short drying time.

Main specifications		FDC6
Loading capacity max	kg	30
Complete overalls	pcs	6
Heating effect	kW	12
Total effect	kW	12,45

Technical specification		FDC6
ELECTRICAL CONNECTIONS		
Electrical connection*		3-N, 400 V, 50 Hz
Fuse	A	20
Total effect	kW	12,45
Heating elements	kW	12
AIR CONNECTIONS		
Outlet exhaust	ø mm/inch	160/6,3
Outlet air flow	m ³ /h	600
SHIPPING DATA		
Net	kg/lbs	200/441
Crated	kg/lbs	40/88,2
Shipping data net	kg/lbs	240/529
Shipping volume	m ³	1,76
OPTIONAL EXTRAS		
Air exchanger 1 vent., 125 mm/4,92 inch	part number	141009
Air exchanger 2 vent., 160 mm/3,6 inch	part number	141018
Rack for gloves	part number	131008
Rack for boots	part number	131009
DIMENSIONS		
Width	mm/inch	1800/71
Depth	mm/inch	800/31,5
Height, inner	mm/inch	1752/69
Height, outhr	mm/inch	1955/77

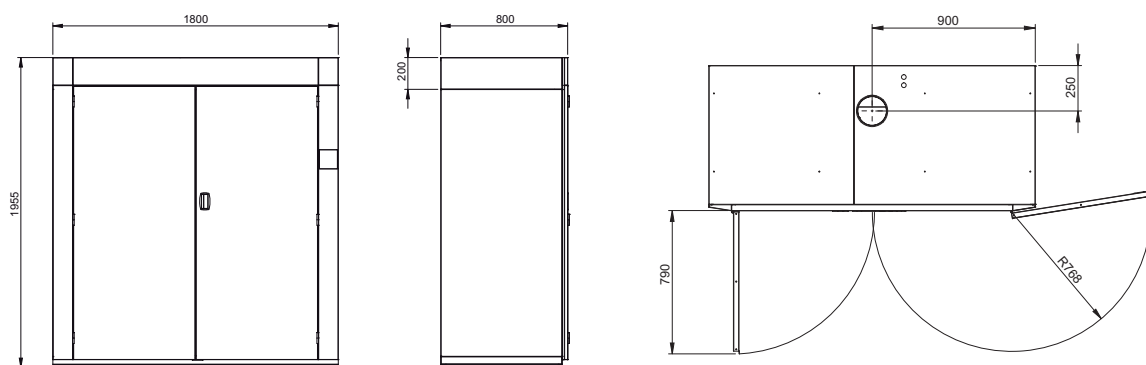
* Other voltage on request.



06-2010 / 538255

The company Primus preserves the right to change the machines and the specification in this leaflet at any time, without prior notice. Details and photographs are only for information and never binding.

www.primuslaundry.com

ISO 9001
ISO 14001
BUREAU VERITAS
Certification

